

# INSTALLATION INSTRUCTIONS

## Troldtekt® Plus K5-F and K5-FU, installed with screws

These instructions apply to installation of Troldtekt® Plus K5-F and K5-FU with screws on wooden battens or steel profile system. If you install Troldtekt® on wooden battens, the battens should be minimum 22x95 mm. You can download installation instructions for the Troldtekt® C60 profile system or wooden battens from [www.troldtekt.co.uk](http://www.troldtekt.co.uk).

### PROFILE DRAWINGS (INDEPENDENT OF SUSPENSION)

#### K5-F

K5-F is available as Troldtekt Plus in the following panel thicknesses:  
**25+20 / 25+40 mm**  
(Note: 25+40 mm cannot be combined with a C60 profile system)

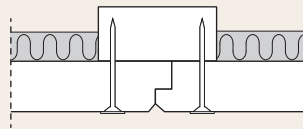

**K5-F**  
Troldtekt Plus  
With 5 mm bevel and rebate

#### K5-FU

K5-FU is available as Troldtekt Plus in the following panel thicknesses:  
**35+20 / 35+40 mm**  
(Note: 35+40 mm cannot be combined with a C60 profile system)

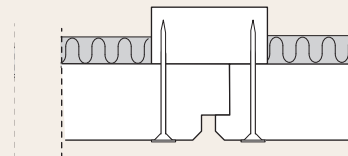

**K5-FU**  
Troldtekt Plus  
With 5 mm bevel and rebate for U-profile

### INSTALLATION (PLEASE READ FULL INSTRUCTIONS BEFORE STARTING WORK)

**1:** Start by installing a complete row of Troldtekt panels along the centre line of the room. Then continue on both sides. It is important that the panels are installed closely together, and the optimum aesthetic effect is obtained by installing the panels in broken bond.

**2:** Fix the panels using Troldtekt screws spaced 20 mm from the edges – as indicated in the figure below. Be careful not to overdrive the washered screws and so cause an indentation in the panel.

**Note:** When installing **600x600 mm** square panels, it is important to ensure that the wood wool fibres run mainly parallel in one direction. To ensure a uniform appearance, install the panels so that the printed Troldtekt texts on the back of the panels all run in the same direction.

### ILLUSTRATION – INSTALLATION K5-F AND K5-FU

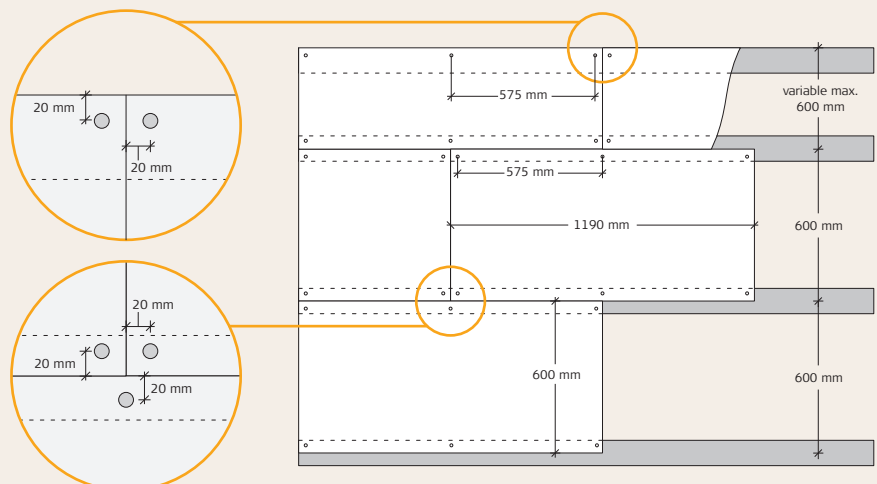

## VAPOUR CHECK

If you need to install a vapour check, we recommend using polyethylene. The vapour check must be placed over the wooden battens, i.e. between the battens and the main beam. Install the vapour check tightly against the insulation.

Please refer to the manufacturer's instructions.

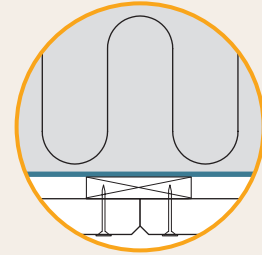

## MODULE DIMENSIONS

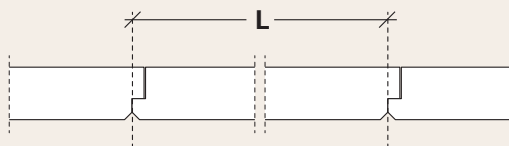

**K5-F**  
Length (L): 600/1190/2000/2400 mm

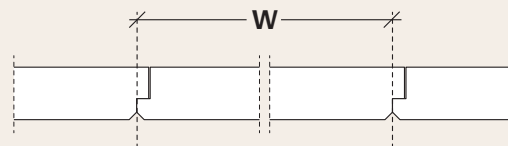

**K5-F**  
Width (W): 600 mm

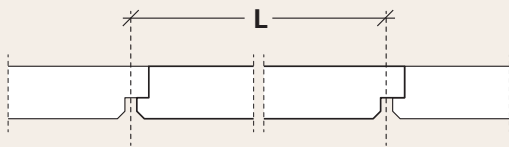

**K5-FU**  
Length (L): 600/1190/2000/2400 mm

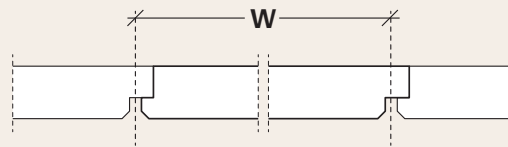

**K5-FU**  
Width (W): 600 mm

## TROLDTEKT® SCREWS

### K5-F

Panel thickness (mm)	Panel length (mm)	Screw dimension (mm)	No. of screws (per panel)	Max. span (mm)
25 / 25+20 / 25+40	600	4,2x45/4,2x50	4	600
	1190		6	
	2000/2400		10	

### K5-FU

Panel thickness (mm)	Panel length (mm)	Screw dimension (mm)	No. of screws (per panel)	Max. span (mm)
35 / 35+20 / 35+40	600	4,2x55/4,2x50	4	600
	1190		6	
	2000/2400		10	

Troldtekt structure screw  
for wood and steel, PH2

4.2x45 mm / 4.2x55 mm



Troldtekt structure screw  
for steel, PH2

4.2x50 mm

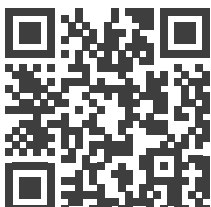

This document reflects Troldtekt's knowledge of certifications, standards, and products at the time of publication.

No rights can be derived from this document.  
Changes, typesetting and printing errors reserved.

The most recent version can be found online by scanning the QR code.

JANUARY 2026 UK&I V01

Troldtekt Limited  
Pembroke  
Leominster  
Tel +44 7555 176055  
sales@troldtekt.co.uk

Herefordshire  
HR6 9LA  
United Kingdom

[www.troldtekt.co.uk](http://www.troldtekt.co.uk)