

INSTALLATION INSTRUCTIONS

for Troldekt® line design, installed with screws

These instructions apply to the installation of Troldekt® line design with screws on wood battens or steel profile system. If you install Troldekt® on wood battens, the battens should be min. 22 x 95 mm. Download installation instructions for the Troldekt® C60 profile system or wood battens from www.troldekt.com.

PROFILE DRAWING (INDEPENDENT OF SUSPENSION)

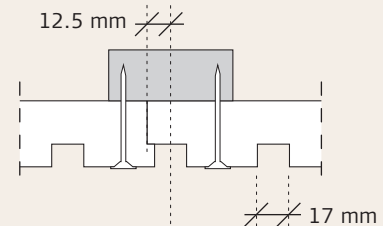

INSTALLATION (PLEASE READ FULL INSTRUCTIONS BEFORE STARTING WORK)

1: Start by installing a complete row of Troldekt panels along the centre line of the room. Then continue along both sides. It is important that the panels are butted tightly up against one another during installation.

NOTE: Line design panels have an overlap along both the long and short edges of the panels. Do not install the panels in broken bond if there is a desire to highlight the transverse grooves. (See the module/groove principle on p. 2).

Troldekt® line design can be installed on both longitudinal

and transverse wood battens. On transverse wood battens, the panels must be installed with a centre-to-centre distance of 595 mm.

2: Fix the panels using Troldekt screws spaced 20 mm from the edges – as shown in the illustrations below. Be careful not to overdrive the screws and so cause an indentation in the panel.

The screws should be screwed into the main surface of the panel (**Fig. 1**) – not into the bottom of the grooves (**Fig. 2**).

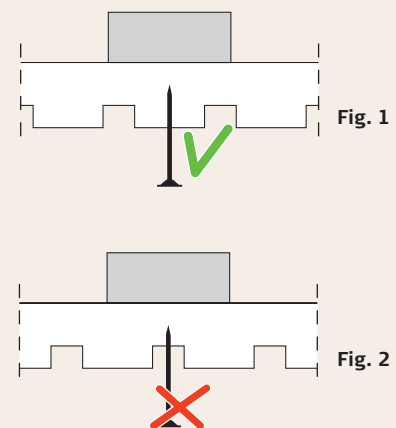
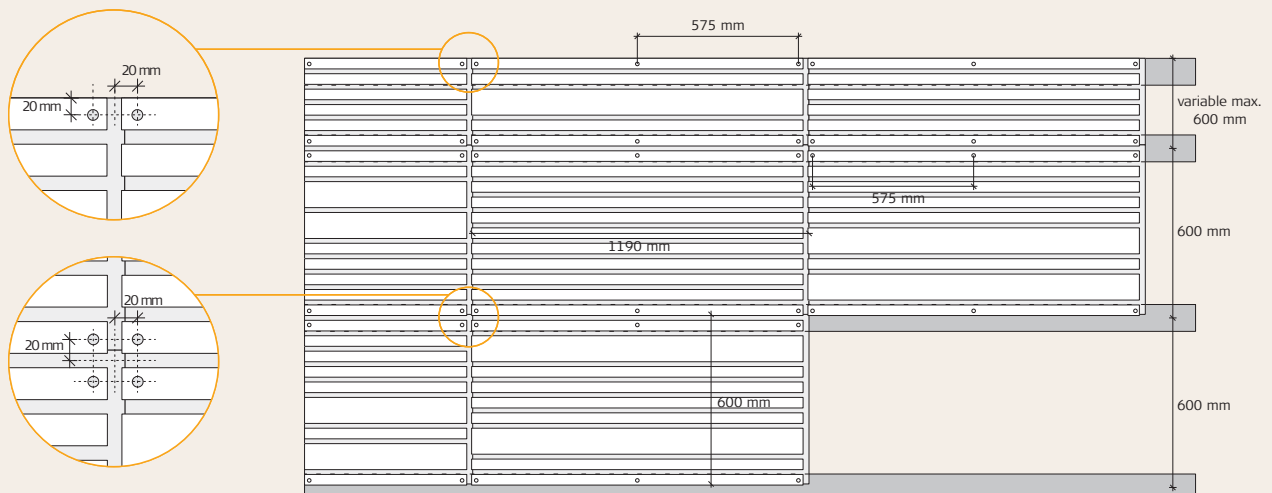

ILLUSTRATION - INSTALLATION



VAPOUR BARRIER

If you need to install a vapour barrier, we recommend using polyethylene plastic sheeting. The vapour barrier must be placed above the wood battens, i.e. between the battens and the foot of the rafters. Install the vapour barrier so it is well-stretched and sits tightly against the insulation.

Please refer to the manufacturer's instructions.

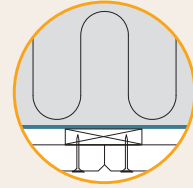

TROLDTEKT® LINE DESIGN VARIANTS

17 mm 37,5 mm

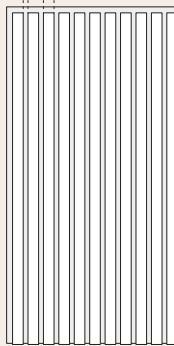

Troldekt® line design 11

17 mm 92 mm 37,5 mm

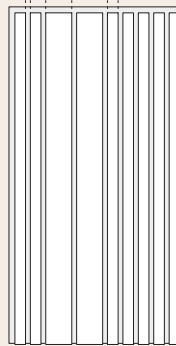

Troldekt® line design 11, 4/6
(without grooves 4 and 6)

17 mm 37,5 mm 92 mm

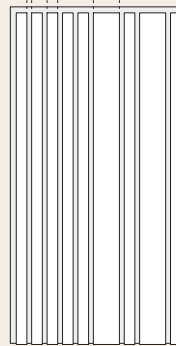

Troldekt® line design 11, 7/10
(without grooves 7 and 10)

17 mm 37,5 mm 92 mm

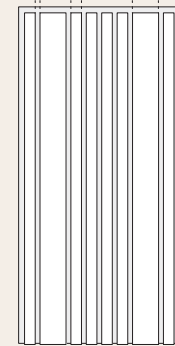

Troldekt® line design 11, 3/9
(without grooves 3 and 9)

MODULE DIMENSIONS

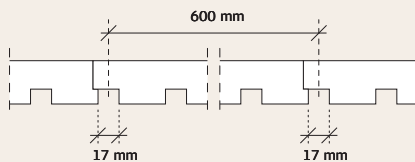

Module width

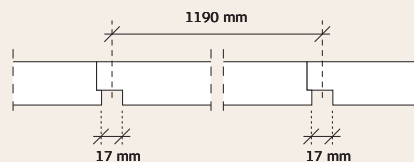

Module length

NOTE! Transverse wood battens must be installed with a centre-to-centre distance of 595 mm.

TROLDTEKT® SCREWS

Troldekt structure screw
for wood and steel, PH2

4.2x45 mm / 4.2x55 mm



Troldekt structure screw
for steel, PH2

4.2x50 mm



This document reflects Troldekt's knowledge of certifications, standards, and products at the time of publication.

No rights can be derived from this document.
Changes, typesetting and printing errors reserved.

The most recent version can be found online by scanning the QR code.

JANUARY 2026 EN V01

Troldekt A/S
Sletvej 2A
DK - 8310 Tranbjerg J
Tel. +45 8747 8100
info@troldekt.dk
www.troldekt.com